

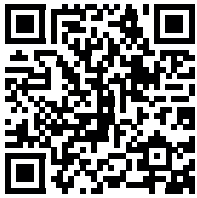

ESBE AB
Bruksgatan 22
SE-333 75 Reftele
www.esbe.eu



ESBE System Units
CIRCULATION UNIT DN25, DN32

SERIES Gxx200



Series GDA200
Series GFA200
Series GRA200

Series GRC200
Series GBA200



LVD 2014/35/EU
EMC 2014/30/EU
RoHS 2011/65/EU
ErP 2009/125/EU

PED 2014/68/EU, article 4.3

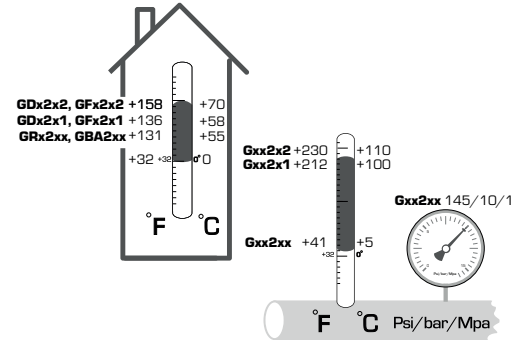

Mtrl.no. 98141121 • Dwg. 7951 • vers. D • Rev. 2026-02-12



Cabling • Dimensions

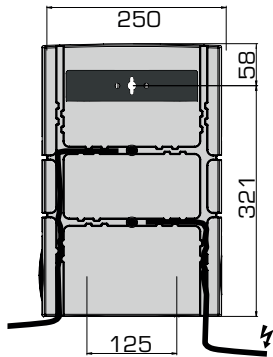

Mounting position

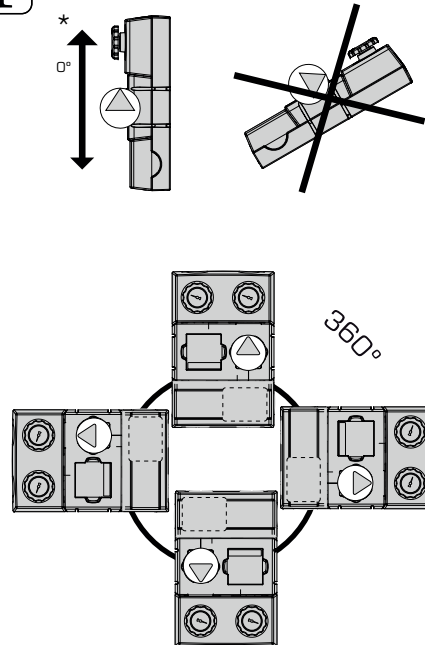

Remove actuator/controller

Series GRA2xx, GBA211, GRC2xx

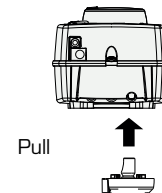
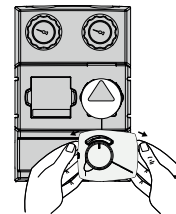

Remove insulation

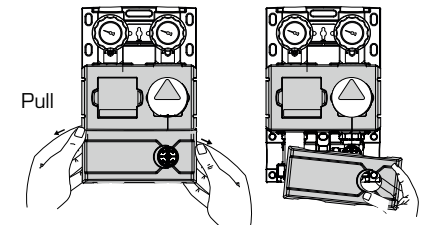
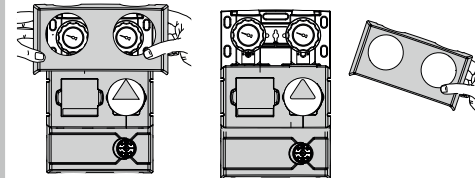

SERIES	FUNCTION
ESBE GDA211 GDA 212	
ESBE GFA211 GFA212	
GRA211 GRA212 GRA231 GRA232	
GRC221 GRC222 GRC241 GRC242	
ESBE GBA211	

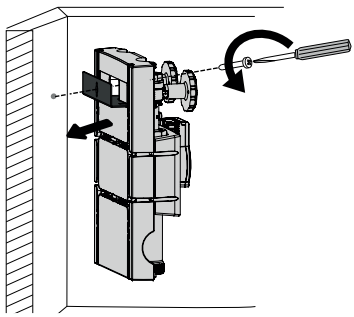
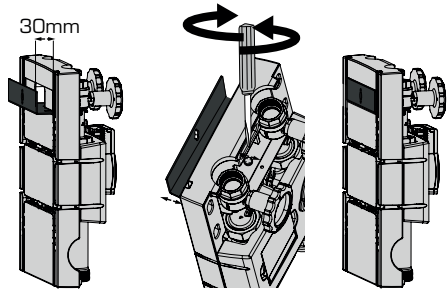
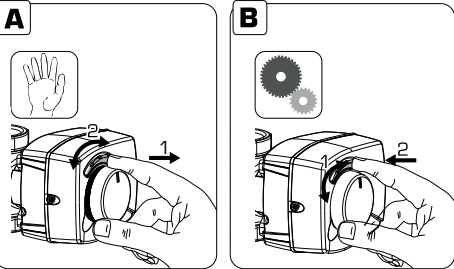
3**Assembling on wall****Adjust wallbracket****i****Commissioning actuator/controller**

<https://esbe.eu/group/products/rotary-actuators>

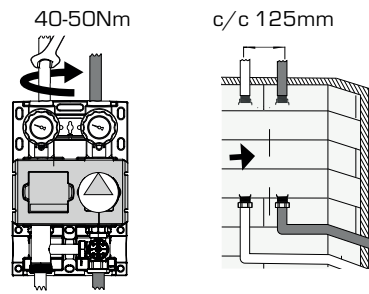
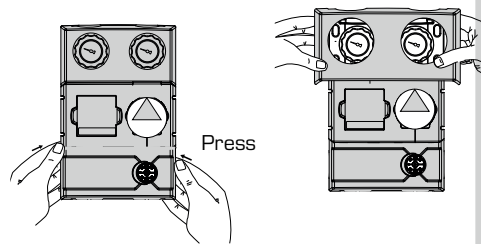
4**Fit supply pipes****Mount the insulation****i****Commissioning fixed temperature**

Series GFA211, GFA212

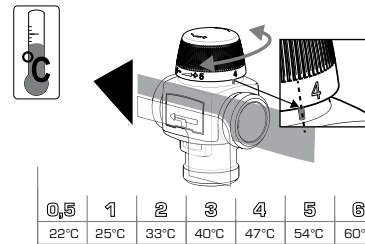

<https://esbe.eu/group/products/thermostatic-mixing-valves>

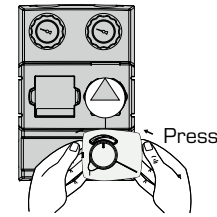
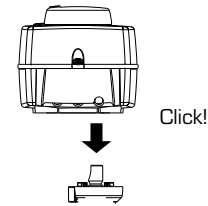
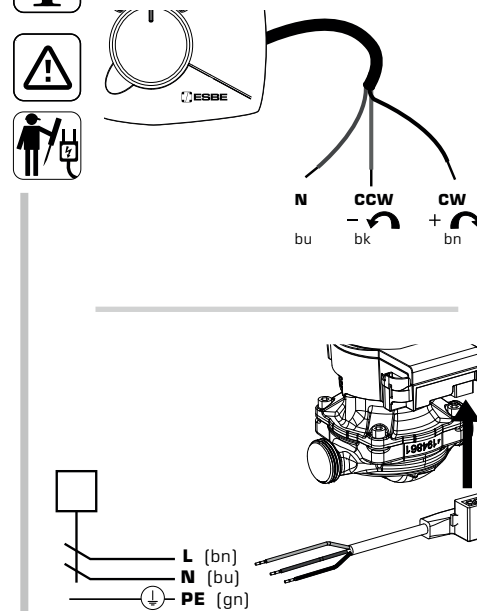
5**Assemble actuator/controller**
Series GRA2xx, GBA211, GRC2xx**QUICK FIT!****i****Electric installation**

i www.esbe.eu

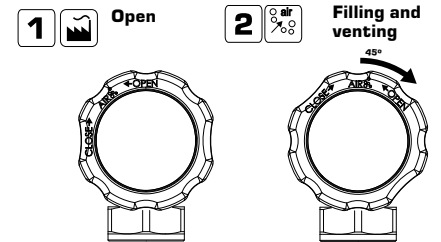
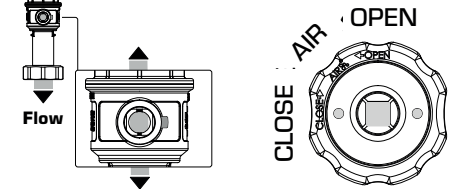
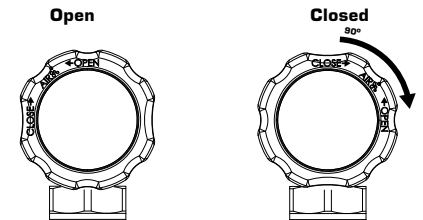
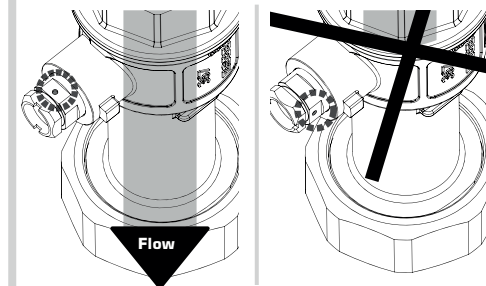
i**Commissioning****Preparation****Filling and venting****Assemble removed knob****Checkvalve position****Drilled mark, indicate check valve position**

Wilo Display

NORMAL OPERATION

FAULT

CONTROL MODE

- Variable differential pressure - $\Delta p-v$
- Constant differential pressure - $\Delta p-c$
- Constant speed

PUMP CURVE
I, II, III

Pump Settings

Hold 8 sec

LED display

Status

Hold 8 sec	LED display icons	1 sec	Locked
Hold 8 sec	LED display icons	1 sec	Unlocked
Hold 3 sec	LED display icons	10 min	Venting
Hold 5 sec	LED display icons	30 sec	Manual restart
1. Hold 2. 3. 4.	LED display icons		Factory setting

Settings navigations

Click

LED display

Control mode

Pump setting

Recommended Alternative

Click 1	LED display icons	Constant speed		Alternative icon
Click 2	LED display icons	Constant speed		Alternative icon
Click 3	LED display icons	Variable differential pressure		Alternative icon
Click 4	LED display icons	Variable differential pressure		Alternative icon
Click 5	LED display icons	Variable differential pressure		Alternative icon
Click 6	LED display icons	Constant differential pressure		Alternative icon
Click 7	LED display icons	Constant differential pressure		Alternative icon
Click 8	LED display icons	Constant differential pressure		Alternative icon
Click 9	LED display icons	Constant speed		Alternative icon

WILO - Faults, Causes and Remedies

LED	Faults	Cause	Remedy
Lights up red	Blocking	Rotor blocked	Activate manual restart or contact customer service
	Contacting/ winding	Winding defective	
Flashes red	Under/overvoltage	Power supply too low/high on mains side	Check mains voltage and operating conditions, and request customer service
	Excessive module temperature	Module interior too warm	
	Short-circuit	Motor current too high	
Flashes red/green	Generator operation	Water is flowing through the pump hydraulics, but there is no mains voltage at the pump	Check the mains voltage, water quantity/pressure and the ambient conditions
	Dry run	Air in the pump	
	Overload	Sluggish motor; pump is operated outside of its specifications (e.g. high module temperature). The speed is lower than during normal operation	

<http://www.esbe.eu/global/en/products/circulation units>

Factory setting

= Factory settings

Type number

Expose application info, using leaflet

7



Grundfos Display

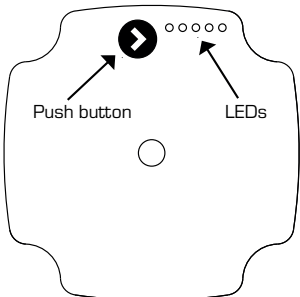

http://www.esbe.eu/global/en/products/circulation_units



Grundfos - Faults, Display and Solutions

FAULT	DISPLAY	SOLUTION
 OFF 0 V	 DISPLAY	 A B C 1/On 0/Off SYSTEM CONTROLLER
 ON 230 V	 RED YELLOW	 1/On 0/Off 5 mm No.2
 ON <160 V	 RED YELLOW	 L PE N
 ON 230 V	 RED YELLOW	 1/On 0/Off

8

Settings navigation

