

CONNECTION KIT

SERIES KTB112, KSB114 AND KWB118

ESBE connection kits for valves with external thread.
One package / port.



KTB100
Internal thread

KSB100
Soldering type

KWB100
Welded type

SUITABLE VALVES

The connection kit series KTB112, KSB114 and KWB118 may most easily be fitted with ESBE control valve:

- Series VLE122, 222
- Series VLE132

TECHNICAL DATA

Max. working pressure: _____ PN 16
 Max. temperature of medium: _____ +150°C
 Min. temperature of medium: _____ -20°C
 Connection: _____ Internal thread, EN 10226-1
 _____ External thread, ISO 228/1

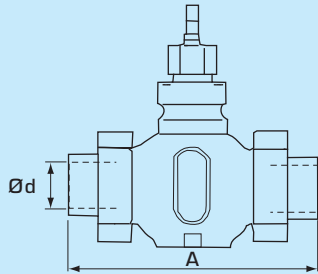

INTERNAL THREAD CONNECTION, SERIES KTB112

Material
 Union nut: _____ Malleable iron casting, galv.
 Union end: _____ Malleable iron casting, galv.
 Standard gasket: _____ Klingsil C4400

SOLDERING TYPE CONNECTION, SERIES KSB114

Material
 Union nut: _____ Brass, CW614N
 Union end: _____ Bronze, SS5204
 Standard gasket: _____ Klingsil C4400

WELDED TYPE CONNECTION, SERIES KWB118

Material
 Union nut: _____ Malleable iron casting, galv.
 Union end: _____ Steel SS1312
 Standard gasket: _____ Novatec eco

SERIES KTB112, FITTINGS INTERNAL THREAD (1 PACKAGE/PORT)

Art. No.	DN	Valves thread	Connection Ød	A (VLE100/VLE200)	A (VLD122/VLD132)	Weight [kg]
2610 07 00	15	G 1"	Rp 1/2"	146	146	0.12
2610 08 00	20	G 1 1/4"	Rp 3/4"	146	146	0.20
2610 09 00	25	G 1 1/2"	Rp 1"	159	159	0.23
2610 10 00	32	G 2"	Rp 1 1/4"	169	194	0.41
2610 11 00	40	G 2 1/4"	Rp 1 1/2"	197	207	0.45
2610 12 00	50	G 2 3/4"	Rp 2"	222	—	0.64

SERIES KSB114, FITTINGS SOLDERING TYPE (1 PACKAGE/PORT)

Art. No.	DN	Valves thread	Connection Ød	A (VLE100/VLE200)	A (VLD122/VLD132)	Weight [kg]
2610 13 00	15	G 1"	15 mm	136	136	0.13
2610 14 00	20	G 1 1/4"	22 mm	146	146	0.19
2610 15 00	25	G 1 1/2"	28 mm	155	155	0.23
2610 16 00	32	G 2"	35 mm	163	188	0.45
2610 17 00	40	G 2 1/4"	42 mm	200	210	0.48
2610 18 00	50	G 2 3/4"	54 mm	232	—	0.77

SERIES KWB118, FITTINGS WELDED TYPE (1 PACKAGE/PORT)

Art. No.	DN	Valves thread	Connection Ød	A (VLE100/VLE200)	A (VLD122/VLD132)	Weight [kg]
2610 01 00	15	G 1"	21.3 mm	182	182	0.12
2610 02 00	20	G 1 1/4"	26.9 mm	182	182	0.19
2610 03 00	25	G 1 1/2"	33.7 mm	187	187	0.25
2610 04 00	32	G 2"	42.4 mm	197	222	0.44
2610 05 00	40	G 2 1/4"	48.3 mm	232	242	0.46
2610 06 00	50	G 2 3/4"	60.3 mm	262	—	0.66